

REV.	DESCRIPTION	DATE	DEVISER	APPROVED
A/0	The last word	07.03.06	W.X.Y	

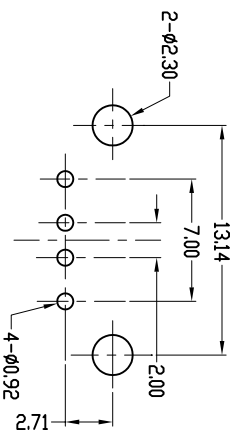

RECOMMENDED P.C.B HOLE LAYOUT
TDP VIEW(TOLERANCE:±0.10)

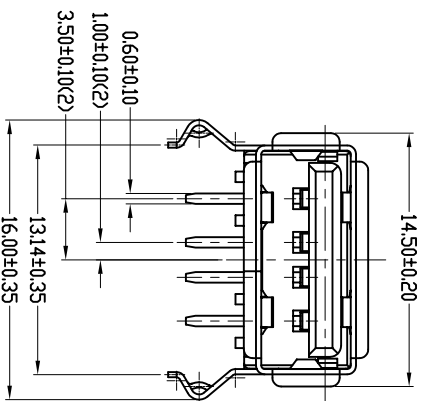
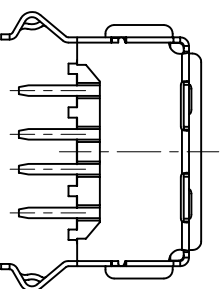
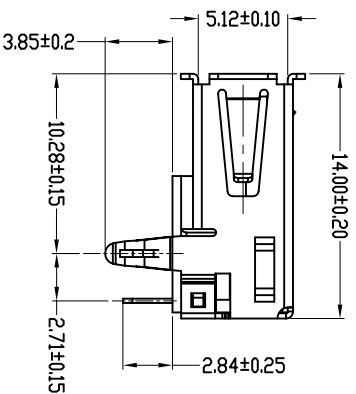
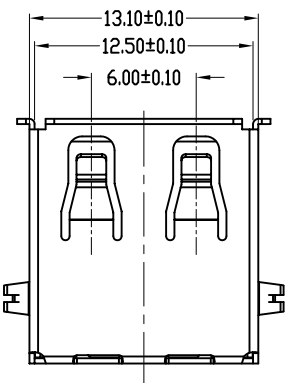
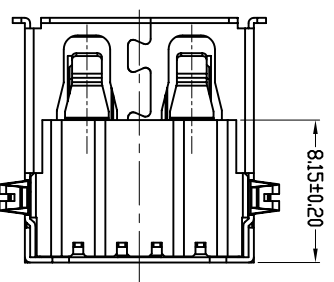

Specification

- 1.Voltage Current Rating:1AMP,30V AC
- 2.Insulation Resistance:1000MΩ Min
- 3.Contact Resistance:30mΩ Max
- 4.Dielectric Withstanding Voltage:500V AC
- 5.Temperature Range:-20°C to +60°C
Remark:48Hours Guarantee by -30°C storage temperature
- 6.Insertion Force: 35 Newtons maximum
- 7.Extraction Force: 10 Newtons minimum

PART NO EXPLAIN:

USB-A1D122F-□□4□

Shell Plate spec:
T=Plateg tin, N=Plateg nickel
Housing Color:
B=Black, N=Nature, W=White
Contact Plate spec:
(0=FU*, 1=3U*, 2=6U*, 3=15U*, 4=30U*)

NO.	VARIETY	MATERIAL	QTY	REMARK
3	Shell	C2680	1	T=0.30 Plateg nickel/Tin
2	Housing	P.B.T	1	UL94V-0 Nature/Black/White
1	Contact	C2680	4	T=0.25 Plateg Gold

CZT® DONGGUAN YIHUA CONNECTOR CO., LTD				
UNIT:	mm	DEVISER:	W.X.Y	TITLE:
3RD:		DESIGN:	W.X.Y	USB A TYPE(FEMALE) DIP 90°
SCALE:	1:1	APPRD:		SHEET:
REV:	A/0	EXAMINE:		1
			CHART NO:	PART NO:
			1014-0122	USB-A1D122F-□□4□
			MATE NO:	