

Single Row

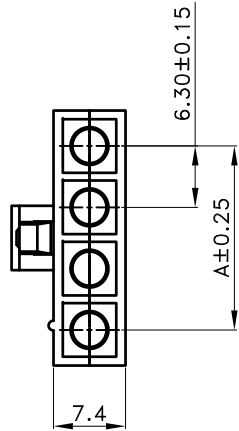

Single Row

Poles	Dimensions(mm)			
	A	B	C	D
01	---	7.3	28.5	18.4
02	6.30	13.6	27.0	17.1
03	12.60	20.0	27.0	17.2
04	18.90	26.2	26.9	17.0

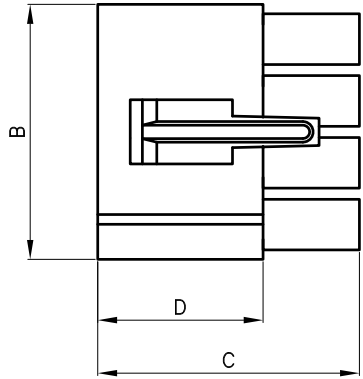
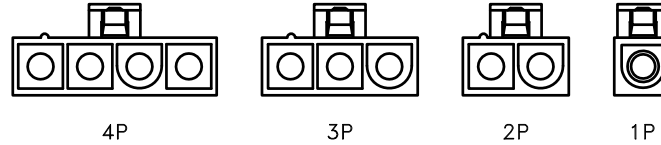

SINGLE TYPE VIEW

■ SPECIFICATIONS

- Current Rating : 9~15A AC/DC
- Withstanding Voltage : 1,500V AC/minute
- Insulation Resistance : 1,000M Ω min
- Temperature Range : - 25°C to + 85°C
- Contact Resistance : 20m Ω max

■ HOUSING

- Part No. : JS-2000W-XX
- Poles : 1, 2, 3, 4, 2x2, 2x3, 3x3, 3x4, 3x5
- Material : Nylon 66 UL94V-2
- Q' ty : 1,000 pcs./Bag

Matrix Row

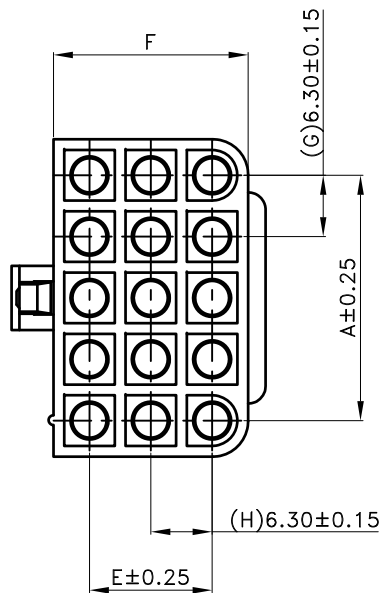
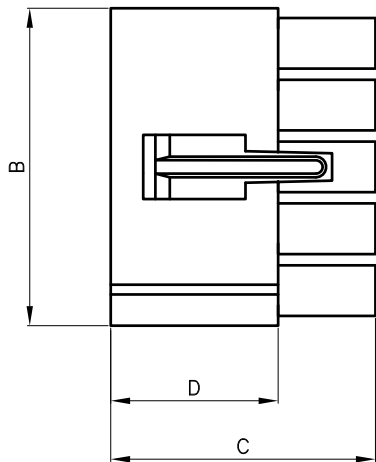

Matrix Row

Poles	Dimensions(mm)					
	A	B	C	D	E	F
2x2	6.30	13.6	27.0	17.2	6.30	13.6
2x3	12.60	19.9	27.0		14.0	
3x3	12.60	19.9	26.9		12.60	20.0
3x4	18.90	26.4	27.0			
3x5	25.20	32.6	27.2			

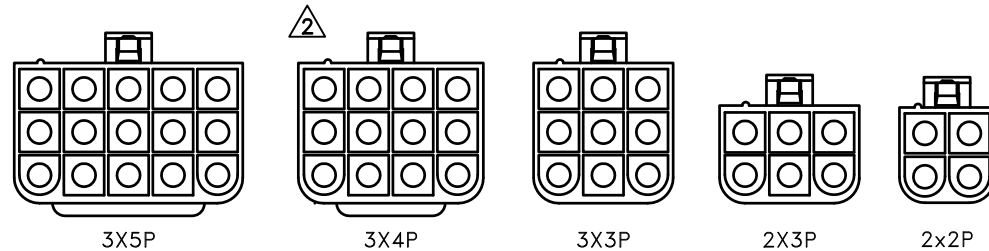

MATRIX TYPE VIEW



喬訊電子工業股份有限公司  
CHYAO SHIUNN  
ELECTRONIC INDUSTRIAL LTD.

PART NO JS-2000W-XX

6.3mm Wire to Wire Connector

APPROVED BY	SCALE	UNIT	TOLERANCE	LTR	REVISION RECORD	NAME	DATE	LTR	REVISION RECORD	NAME	DATE
張育瑞		mm	.0 ±0.30	△	變更原因遺失	余秀麗	2005/05/15	△			
CHECKED BY	PROJ	VER NO.	.00 ±0.20	△	修改產品外觀結構	王誠賢	2011/12/01	△			
黃科源	⊕ □	a2	.000 ±0.10	△				△			
DRAWN BY	DATE	SIZE	ANGLE						CUSTOMER		
王誠賢	2011/12/01	A4	0° ±1°	△							
			.0° ±	△							
			SHEET 1/1	△							Conforms to The RoHS Instruction